

400

Technical specification

L A G O O N

Contents

TECHNICAL DATAS	3
CONSTRUCTION.....	4
SAILS AND RIGGINGS	4
HARDWARE	4
MOORING.....	4
VARIOUS EQUIPMENTS.....	5
MOTORISATION.....	5
PLUMBING.....	5
ELECTRICS	6
DECK LAYOUT	7
TRANSOM.....	7
AFT COCKPIT	7
HELM STATION	7
FORWARD COCKPIT.....	7
BOW LOCKERS	7
INTERIOR LAYOUTS.....	8
GENERALITIES.....	8
3 CABINS, 2 BATHROOMS.....	9
3 CABINS, 3 BATHROOMS.....	12
4 CABINS, 2 BATHROOMS.....	15
4 CABINS, 4 BATHROOMS.....	17

TECHNICAL DATAS

Length over all LOA	11,97 m / 39'3"
Beam over all	7,25 m / 23'9"
Mast clearance	20,30 m / 66'7"
Draft	1,21 m / 4'00"
Displacement (ECC)	10,35 t / 22817 Lbs
Upwind sail area	84 m ² / 904 sq.ft.
Full batten mainsail	56m ² / 603 sq.ft.
Square top mainsail (option)	60,5m ² / 651 sq.ft.
Furling genoa	28 m ² / 377 sq.ft.
Code 0 (option)	73 m ² / 785 sq.ft.
Fresh water capacity	1 x 300 l / 79 US gal
Fuel capacity	2 x 200 l / 2 x 53 US gal
Engines	2 x 29 hp to 2 x 45 hp Common Rail
Architects	Marc Van Peteghem & Vincent Lauriot Prévost (VPLP)
Interior Design	Nauta Design
Nb of berths	6 to 12
EC Certification	A : 10 ; B : 14 ; C : 20 ; D : 20

CONSTRUCTION

- Polyester and high quality anti-osmotic resin
- Hull and deck laminated by infusion
- Balsa core hull, solid laminate under water line, white gel coat
- Balsa core bridge deck and deck
- Laminated marine plywood bulkheads

SAILS AND RIGGINGS

SAILS

- 1 high roach mainsail in Dacron with battens and LAGOON logo, 2 straps
- 1 furling genoa in Dacron with UV protective band, 1 strap

RIGGING

- Anodized aluminum mast put on the roof
- Double spreaders rig
- Anodized aluminum boom
- 2 encased shrouds
- 1 forestay shrouds on transversal cross beam
- 2 adjustable lazy-jacks

RUNNING RIGGING

- 1 double purchase mainsail halyard
- 1 genoa halyard
- 1 mainsail sheet led back to helm station with adjustment pulley and traveler on hard top Bimini
- 2 genoa sheets led back to helm station on port side

HARDWARE

- 3 winches 46.2STA at helm station opposite port stern side of coachroof
- 2 winch handles with holder
- 2 adjustable genoa sheet travelers
- 1 lock on deck for genoa
- Anodized aluminum crossbeam with mooring point for the genoa furler, anchor roller and navigation lights

MOORING

- Composite longitudinal crossbeam with avec integrated chain run and mooring cleats
- 8 mooring cleats
- 1000W 12V electrical windlass on the deck, horizontal gypsy (chain 10mm)
- Access to the chain locker through a large hatch on s/s struts, starboard forward
- Anchor roller on forward aluminum cross beam

VARIOUS EQUIPMENTS

- S/s pulpits and pushpits with on port flag pole and buoy bracket
- Height of the stanchions : 610 mm
- 2 ranges of s/s life line on the sides
- 3 ranges of s/s life line on aft cross beam
- S/s handrails

MOTORISATION

- 2 diesel engines YANMAR 3YM30 29cv sail drive
- 2 blades fixe propeller
- Sea water filter
- Mechanical engine throttles at the helm station
- Air extraction by 12V extractor
- Ventilation of the engine compartment : natural suction and forced extraction in the aft transom
- Sound-proofing of the engine compartment
- Fuel circuit :
 - 2 rotomoulded tanks of 200 liters under the aft port and starboard cabin
 - Fuel filter systems with water separator
 - Exhaust with wet mufflers
 - Fuel shut off valve
 - Air inlet on the aft transom
 - Gauge at the general distribution panel
- Access to the engine compartments through hatches in the aft transom

PLUMBING

Fresh water circuit:

- Fresh water tank : 300L with gauge at the chart table
- Fresh water circuit with 1 main water group in the forward portside cabin
- 40L water heater, starboard engine exchanger

Grey water:

- Shower and washbasin drain to grey water tank and automatic pump

Black water:

- 2 cabins, 2 heads version :
 - 2 tanks 80L (total 160L)
- 3 cabins, 2 heads version :
 - 3 tanks 80L (total 240L)
- 4 cabins, 2 heads version :
 - 2 tanks 80L (total 160L)
- 4 cabins, 4 heads version :
 - 4 tanks 80L (total 320L)
- Holding tank with water and deck emptying system

Bilge pump circuit:

- 2 manual bilge pumps in aft cockpit
- 1 automatic and electric bilge pump in each hull (manual activating from the electrical panel)

ELECTRICS

Power circuit:

- 2 alternators 12V 80AH
- 2 start batteries 12V 110A
- 2 service batteries 12V 140Ah

Service batteries breaker under the bed of the aft port cabin

Start batteries breaker under the aft beds (portside and starboard)

Distribution Electric panel:

- 12V backlit general distribution panel in the salon, next to the chart table
- LCD display with: voltmeter, ammeter, circuit breakers, low voltage alarm for batteries

Lighting:

- 12V LED outside lighting
- Chart table light with red LED light
- 12V LED inside lighting
- Navigation lights
- 12V engine compartment light

DECK LAYOUT

TRANSOM

- Hot/cold deck shower on portside
- S/s telescopic swim ladder with fixe handles on portside

AFT COCKPIT

- Large cockpit usable as a deck salon, protected by a hard top bimini
- "U" bench on starboard with :
 - 1 locker under the starboard bench
 - 1 locker under the aft bench
 - 1 technical locker for the generator under the forward bench
- 1 "Lazy boy" area on port with a locker (behind the helm station) with gas bottle possibility (6kg)
- Varnished cockpit table exchangeable with the low salon table
- Self-draining cockpit with wooden grating

HELM STATION

- Helm station on portside on the roof bulkhead
- 2 seats helm bench
- Covered steering wheel with brake
- Instrumentation console
- Engine throttles
- Storage bag for halyards
- Foot rest
- Access staircase from the cockpit with s/s guardrail

FORWARD COCKPIT

- Large hatch on portside with s/s gas struts and locks to access to the water tank
- Trampoline with nylon thread

BOW LOCKERS

- Access through opening deck hatches with lock
- S/s ladder
- Grey painting (berth option)

INTERIOR LAYOUTS

GENERALITIES

- Interior woodwork in marine plywood and Alpi oak
- Dark brown laminated floor (Milano)
- S/s handrail leather covered
- Fabric-covered plywood ceiling panels or fiberglass liners in cabins and wash rooms
- Fabric-covered plywood on hull liner in cabins
- Polyester ceiling and fabric-covered plywood in the salon

Standing headroom

Salon :	2.12m
Aft cabin :	2.00 m
Forward cabin:	2.08m
Bathroom :	2.00 m

Mattress and upholstery

- Marine mattresses made of multi-layer alveolar foam with several densities (tick. 130mm)
- Mattresses treatment: anti-microbial, anti-bacterial, non-allergenic, anti-dust mite
- Standard upholstery as indicated on Lagoon sample book
- Synthetic fabrics adapted to marine environment:
 - washable (40°C)
 - U.V. resistant
 - water repellent, with anti-stain treatment
- Blackout curtains in the cabins and salon

Lighting

- 12V LED ceiling spotlights
- 12V LED reading lights headboard
- 12V LED reading lights at the chart table
- 12V lighting in the engine compartment

Available version

- 3 cabins, 2 bathrooms
- 3 cabins, 3 bathrooms
- 4 cabins, 2 bathrooms
- 4 cabins, 4 bathrooms

3 CABINS, 2 BATHROOMS



3 cabines 2 SDB / 3 cabin 2 bathrooms

SALON

- Large panoramic view salon
- Aluminum sliding door and window with locker for the access to the cockpit, can be locked open or closed
- 6 people varnished salon table exchangeable with the polyester table from the cockpit
- « L » bench on port
- Double berth in the salon (option)
- 3 lockers under the bench
- 2 opening hatches on the front windows

CHART TABLE

- 1 sliding seat for chart table and dining table
- Desk with flaps
- 3 drawers storage unit
- Instrumentation console with panel to install the electronics

GALLEY

- « L » shape galley on starboard
- Compact countertop with wooden strips
- Double large s/s sink with hot/cold mixer tap
- Cupboard under sink with waste bin behind of the door
- 3 burners stove and enameled gas oven
- 3 bottle storage
- 3 storage drawers
- 130L refrigerator 12V
- 1 high cupboard with 3 doors with flaps
- 1 cupboard on portside

PORTSIDE HULL

AFT CABIN

- 1 double bed with front and lateral access 2,00m x 1,44m x 1.00 m at foot
- Nightstand on headboard and inboard side
- 1 under bed drawer
- 1 wardrobe – outboard side
- 1 opening deck hatch
- 1 opening hull porthole
- 1 opening hull porthole on top of the headboard
- 1 fixe hull window

SHARED BATHROOM

- Composite countertop
- Washbassin with hot/cold mixer tap
- 1 high cupboard 2 doors with mirror
- 1 low cupboard with shelves
- 1 towel holder
- 1 cup holder
- Big size manual toilet
- Separate shower with Plexiglas door :
 - 1 shower column with soap holder
 - 1 shower head holder
 - 1 hot/cold mixer tap
- 1 opening deck hatch

FORWARD CABIN

- Convertible bed : 1 double or 2 single
 - 1 double bed: 2.06 m x 1.76 m x 1, 16 m at foot
 - 2 single beds: 2.06 m x 0.69 m x 0, 58 m at foot
- 1 underbed storage
- 1 nighstand at the foot of the bed
- 1 drawer and 2 cupboards in front of the bed
- 1 wardrobe – outboard side
- 1 opening deck hatch
- 1 opening hull porthole
- 1 fixe hull window

STARBOARD HULL

CABIN

- 1 double bed with front and lateral access 2,00m x 1,44m x 1.00 m at foot
- 1 under bed drawer
- Nighstand – outboard side
- 2 bookshelves – outboard side
- 1 low storage
- 1 sofa 2 seats
- 1 desk with flap, 3 drawers and 1 seat
- Above the desk :1 bookshelve + high cupboard 2 doors
- 1 full high cupboard with 3 drawers + 1 wardrobe
- 1 full high cupboard with 2 doors and shelves
- 3 opening deck hatches
- 1 opening hull porthole
- 1 fixe hull window

BATHROOM

- Composite countertop
- Washbassin with hot/cold mixer tap
- 1 high cupboard, doors with mirror
- 1 low cupboard with shelves
- 1 towel holder
- 2 cup holders
- Big size manual toilet
- Separate shower with Plexiglas door :
 - 1 shower column with soap holder
 - 1 shower head holder
 - 1 hot/cold mixer tap
 - 1 grating
- 1 opening deck hatch

3 CABINS, 3 BATHROOMS



3 cabines 3 SDB / 3 cabin 3 bathrooms

SALON

- Large panoramic view salon
- Aluminum sliding door and window with locker for the access to the cockpit, can be locked open or closed
- 6 people varnished salon table exchangeable with the polyester table from the cockpit
- « L » bench on port
- Double berth in the salon (option)
- 3 lockers under the bench
- 2 opening hatches on the front windows

CHART TABLE

- 1 sliding seat for chart table and dining table
- Desk with flaps
- 3 drawers storage unit
- Instrumentation console with panel to install the electronics

GALLEY

- « L » shape galley on starboard
- Compact countertop with wooden strips
- Double large s/s sink with hot/cold mixer tap
- Cupboard under sink with waste bin behind of the door
- 3 burners stove and enameled gas oven
- 3 bottle storage
- 3 storage drawers
- 130L refrigerator 12V
- 1 high cupboard with 3 doors with flaps
- 1 cupboard on portside

PORTSIDE HULL

AFT CABIN

- 1 double bed with front and lateral access 2,00m x 1,44m x 1.00 m at foot
- Nightstand on headboard and inboard side
- 1 under bed drawer
- 1 wardrobe – outboard side
- 1 opening deck hatch
- 1 opening hull porthole
- 1 opening hull porthole on top of the headboard
- 1 fixe hull window

AFT BATHROOM

- Composite countertop
- Washbassin with hot/cold mixer tap
- 1 high cupboard, doors with mirror
- 1 towel holder
- 1 cup holder
- Big size manual toilet
- Separate shower with Plexiglas door :
 - 1 shower column with soap holder
 - 1 shower head holder
 - 1 hot/cold mixer tap
- 1 opening deck hatch

FORWARD CABIN

- Convertible bed : 1 double or 2 single
 - 1 double bed : 2.06 m x 1.76 m x 1, 16 m at foot
 - 2 single beds: 2.06 m x 0.69 m x 0, 58 m at foot
- 1 underbed storage
- 1 nighstand at the foot of the bed
- 1 drawer and 2 cupboards in front of the bed
- 1 wardrobe – outboard side
- 1 opening deck hatch
- 1 opening hull porthole
- 1 fixe hull window

FORWARD BATHROOM

- Composite countertop
- Washbassin with hot/cold mixer tap
- 1 high cupboard, doors with mirror
- 1 towel holder
- 1 cup holder
- Big size manual toilet
- Separate shower with Plexiglas door :
 - 1 shower column with soap holder
 - 1 shower head holder
 - 1 hot/cold mixer tap
- 1 opening deck hatch

STARBOARD HULL

CABIN

- 1 double bed with front and lateral access 2,00m x 1,44m x 1.00 m at foot
- 1 under bed drawer
- Nighstand – outboard side
- 2 bookshelves – outboard side
- 1 low storage
- 1 sofa 2 seats
- 1 desk with flap, 3 drawers and 1 seat
- Above the desk :1 bookshelve +high cupboard 2 doors
- 1 full high cupboard with 3 drawers + 1 wardrobe
- 1 full high cupboard with 2 doors and shelves
- 3 opening deck hatches
- 1 opening hull porthole
- 1 opening hull porthole on top of the headboard
- 1 fixe hull window

BATHROOM

- Composite countertop
- Washbassin with hot/cold mixer tap
- 1 high cupboard, doors with mirror
- 1 low cupboard with shelves
- 1 towel holder
- 2 cup holders
- Big size manual toilet
- Separate shower with Plexiglas door :
 - 1 shower column with soap holder
 - 1 shower head holder
 - 1 hot/cold mixer tap
 - 1 grating seat
- 1 opening deck hatch

4 CABINS, 2 BATHROOMS



4 cabines 2 SDB / 4 cabin 2 bathrooms

SALON

- Large panoramic view salon
- Aluminum sliding door and window with locker for the access to the cockpit, can be locked open or closed
- 6 people varnished salon table exchangeable with the polyester table from the cockpit
- « L » bench on port
- Double berth in the salon (option)
- 3 lockers under the bench
- 2 opening hatches on the front windows

CHART TABLE

- 1 sliding seat for chart table and dining table
- Desk with flaps
- 3 drawers storage unit
- Instrumentation console with panel to install the electronics

GALLEY

- « L » shape galley on starboard
- Compact countertop with wooden strips
- Double large s/s sink with hot/cold mixer tap
- Cupboard under sink with waste bin behind of the door
- 3 burners stove and enameled gas oven
- 3 bottle storage
- 3 storage drawers
- 130L refrigerator 12V
- 1 high cupboard with 3 doors with flaps
- 1 cupboard on portside

PORTSIDE HULL

AFT CABIN

- 1 double bed with front and lateral access 2,00m x 1,44m x 1.00 m at foot
- Nightstand on headboard and inboard side
- 1 under bed drawer
- 1 wardrobe – outboard side
- 1 opening deck hatch
- 1 opening hull porthole
- 1 opening hull porthole on top of the headboard
- 1 fixe hull window

SHARED BATHROOM

- Composite countertop
- Washbassin with hot/cold mixer tap
- 1 high cupboard 2 doors with mirror
- 1 low cupboard with shelves
- 1 towel holder
- 1 cup holder
- Big size manual toilet
- Separate shower with Plexiglas door :
 - 1 shower column with soap holder
 - 1 shower head holder
 - 1 hot/cold mixer tap
- 1 opening deck hatch

FORWARD CABIN

- Convertible bed : 1 double or 2 single
 - 1 double bed : 2.06 m x 1.76 m x 1, 16 m at foot
 - 2 single beds: 2.06 m x 0.69 m x 0, 58 m at foot
- 1 underbed storage
- 1 nighstand at the foot of the bed
- 1 drawer and 2 cupboards in front of the bed
- 1 wardrobe – outboard side
- 1 opening deck hatch
- 1 opening hull porthole
- 1 fixe hull window

STARBOARD HULL

Identical to the portside hull

4 CABINS, 4 BATHROOMS

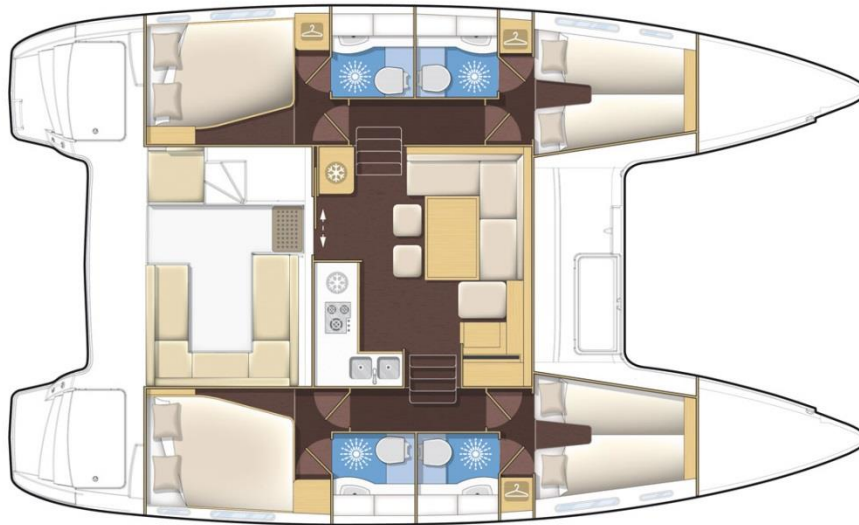

4 cabines 4 SDB / 4 cabin 4 bathrooms

SALON

- Large panoramic view salon
- Sliding door and window with aluminum locker for the access to the cockpit, can be locked open or closed
- 6 people varnished salon table exchangeable with the polyester table from the cockpit
- « L » bench on port
- Double berth in the salon (option)
- 3 lockers under the bench
- 2 opening hatches on the front windows

CHART TABLE

- 1 sliding seat for chart table and dining table
- Desk with flaps
- 3 drawers storage unit
- Instrumentation console with panel to install the electronics

GALLEY

- « L » shape galley on starboard
- Compact countertop with wooden strips
- Double large s/s sink with hot/cold mixer tap
- Cupboard under sink with waste bin behind of the door
- 3 burners stove and enameled gas oven
- 3 bottle storage
- 3 storage drawers
- 130L refrigerator 12V
- 1 high cupboard with 3 doors with flaps
- 1 cupboard on portside

PORTSIDE HULL

AFT CABIN

- 1 double bed with front and lateral access 2,00m x 1,44m x 1.00 m at foot
- Nightstand on headboard and inboard side
- 1 under bed drawer
- 1 wardrobe – outboard side
- 1 opening deck hatch
- 1 opening hull porthole
- 1 fixe hull window

AFT BATHROOM

- Composite countertop
- Washbassin with hot/cold mixer tap
- 1 high cupboard, doors with mirror
- 1 towel holder
- 1 cup holder
- Big size manual toilet
- Separate shower with Plexiglas door :
 - 1 shower column with soap holder
 - 1 shower head holder
 - 1 hot/cold mixer tap
- 1 opening deck hatch

FORWARD CABIN

- Convertible bed : 1 double or 2 single
 - 1 double bed: 2.06 m x 1.76 m x 1, 16 m at foot
 - 2 single beds: 2.06 m x 0.69 m x 0, 58 m at foot
- 1 underbed storage
- 1 nighstand at the foot of the bed
- 1 drawer and 2 cupboards in front of the bed
- 1 wardrobe – outboard side
- 1 opening deck hatch
- 1 opening hull porthole
- 1 fixe hull window

FORWARD BATHROOM

- Composite countertop
- Washbassin with hot/cold mixer tap
- 1 high cupboard, doors with mirror
- 1 towel holder
- 1 cup holder
- Big size manual toilet
- Separate shower with Plexiglas door :
 - 1 shower column with soap holder
 - 1 shower head holder
 - 1 hot/cold mixer tap
- 1 opening deck hatch

STARBOARD HULL

Identical to the portside hull



162, quai de Brazza
CS 81217
33072 Bordeaux Cedex - France
Tél. 33 + (0) 557 80 92 80
E-mail : info@cata-lagoon.com
www.cata-lagoon.com