

352



RIG DIMENSIONS

	CLASSIC		FURLING	
I	43.31 ft	13.20 m	43.31 ft	13.20 m
J	12.40 ft	3.78 m	12.40 ft	3.78 m
P	37.24 ft	11.35 m	37.24 ft	11.35 m
E	13.78 ft	4.20 m	13.78 ft	4.20 m
Total Sail Area (140% Genoa)	660 sq ft	61.32 sq m	634 sq ft	58.90 sq m

SPECIFICATIONS

L.O.A.	35' 0"	10.67 m
Hull Length	34' 2"	10.40 m
L.W.L.	31' 1"	9.47 m
Beam	12' 6"	3.81 m
Draft	5' 0"	1.52 m
Displacement	12,000 lb	5443 kg
Ballast	3750 lbs	1701 kg
Water	100 gals	400 l.
Fuel	24 gals	91 l.
Engine	28 hp	

SPECIFICATIONS

OCEANIS 352

Includes all standard equipment listed below, F.O.B. Marion, S.C.

CONSTRUCTION:

HULL: Laminated G.R.P. hull with internal fiberglass hull liner, reinforced with unidirectional roving.
DECK: Balsa sandwich for stiffness plus thermal and acoustic insulation. Deck liner for additional insulation and easy maintenance.
INTERIOR WOOD: Varnished Cherry Stained Mahogany

DECK EQUIPMENT:

Bow Pulpit in s/s, with red/green navigation lights
Stem Pulpit in s/s with ring buoy and flag staff supports
(2) stem rail seats
(6) x 20" stanchions with double stelines and gates port and starboard
(2) teak handrails on coachroof
Extruded anodized aluminum toerail
Reinforced anodized aluminum sternhead fitting with 2 mooring fairleads and 1 anchor roller
(4) roller fairleads amidships and aft
Stem anchor roller
(4) anodized aluminum mooring cleats
Chain locker with windlass support and ring bolt for anchor rode
(2) coachroof mounted genoa sheet tracks with roller bearing cars
Genoa sheet turning blocks with stoppers
Coachroof mounted mainsheet traveler with roller bearing car
(2) sheek blocks with (5) sheaves for lines led to cockpit
(6) spinlock stoppers for halyards, genoa furler line, mainsail furler and mainsheet
(2) coachroof mounted Lewmar 44 ST0 winches for halyards and genoa sheets
(2) sail lockers, one full depth, one shallow
(1) molded locker for gas bottle
Steering wheel 42" diameter with console for engine controls, optional electronics, and drink holders
Access via fold down door to stern swim platform
Folding swim ladder
Cockpit shower on transom
Stem light
Teak inlaid cockpit seating
Transom fender

RIGGING

Anodized aluminum furling mast and boom, two sets of spreaders
Rigid Boom Vang
5/8 rigging (forestay, forward lower shrouds, aft lower shrouds, upper shrouds, intermediates, twin backstays)
Running rigging (1 mainsheet, 2 genoa sheets, 1 mainsail halyard, 1 genoa halyard, traveler cross haul lines, boomvang pennant, furling control lines)
Genoa furling with drum above deck

Sails:
Furling mainsail
140% Furling genoa

ACCOMMODATIONS:

FORWARD CABIN

Double berth 7'3" x 5'11"
Mattress high density foam with removable cover
Hanging locker
Storage space beneath berth
(2) halogen reading lights
(1) overhead light
(1) opening hatch 20" x 14" with roller blind
(2) opening ports in coachroof 13" x 7" with curtains

SALON TO STARBOARD

Salon table with L shaped settee. (Can be transformed into double berth)
Bottle storage behind the back of settee
Storage space beneath settee
(2) Halogen overhead lights
(1) reading light
(1) opening deck hatch 20" x 14" with roller blind
(1) fixed hatch above the table with curtain
(1) fixed hull porthole

SALON TO PORT

(1) settee seat with storage beneath
(1) chart table facing aft with storage space outboard
(12) function electrical panel
(1) electronics installation panel
(1) halogen overhead light
(1) red/white light over chart table
(1) 26" x 7.5" opening port in coachroof

GALLEY TO PORT

Headroom 6'3"
Tern stainless steel sinks with mixing faucet
Pressurized hot and cold fresh water
Trash can
(2) burner stove with oven, stainless steel safety bar
Icebox (4.5 cubic feet) insulated with polyurethane foam
12 volt electric refrigeration unit
6 gallon hot water heater
Storage lockers
Dust pan in cabin sole
(1) halogen overhead light
(1) fluorescent light
(2) opening ports on the coaming 15" x 7.5"
(1) opening hatch 10.25" x 10.25" with roller blind
(1) fixed hull port

HEAD

Headroom 6' 1"
Head compartment molded in one piece for easy cleaning
Wash basin with mixing faucet for pressurized hot and cold water
Shower
Stowage locker
Mirror

USCG approved manne head with holding tank
Open molded wet locker
Discharge of used water via 12v electrical pump
(1) halogen overhead light
(1) opening hatch 15" x 7.5" with blind

COMPANIONWAY

Headroom: 6'3"
Removable steps for access to engine, fiberglass with non-skid covering
(2) wood grabrails
Plexiglass sliding panel
Plexiglass drop boards

AFT CABIN

(1) cabin with double berth (6'7" x 6'3")
Mattress 4.75" thick with removable cover
Lockers
Hanging locker
Storage space
(1) engine access panel
(2) reading lights
(1) opening hatch 10.25" x 10.25" with blind
(1) opening port in the coaming 15" x 7.5"
(1) fixed hull port
Curtains

ENGINE EQUIPMENT

27 hp, 3 cylinder diesel
24 gallon fuel tank
Engine compartment with eggshell foam insulation
Shaft protected by fiberglass molded skeg
3 bladed fixed prop 18 x 12 RH
Exterior engine panel on coaming protected by plexiglass
Hourmeter
Fuel gauge

MISCELLANEOUS EQUIPMENT

(1) manual bilge pump
(1) electric bilge pump
(2) water tanks (2 x 50 gals) built into hull liner
(1) propane bottle
Stereo with 2 speakers
Stemral seats
Autohelm ST50 Plus Tridata
Standard Horizon Eclipse + VHF with antenna
Teak flagstaff
Owner's manual

ELECTRICAL

110v shore power system with 7 outlets
Battery charger 20 amp
(1) 75 amp group 24 battery
(1) 200 amp 4C battery

KEEL

Lead bulb keel with winglets

INTERIOR LAYOUT

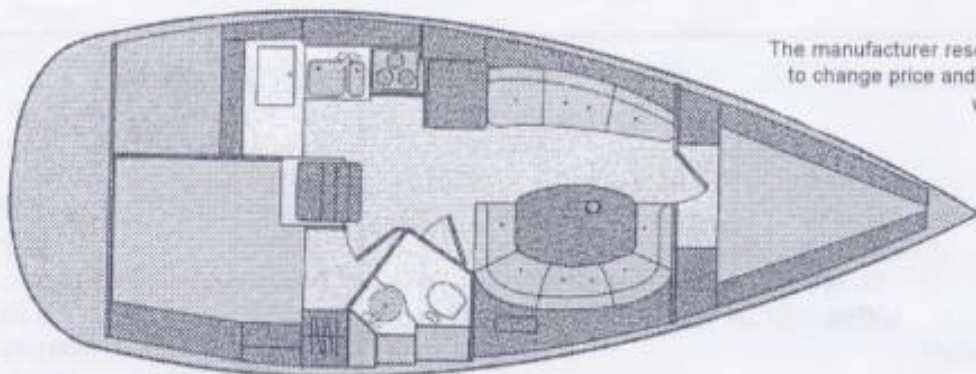

The manufacturer reserves the right to change price and specifications without notice.