

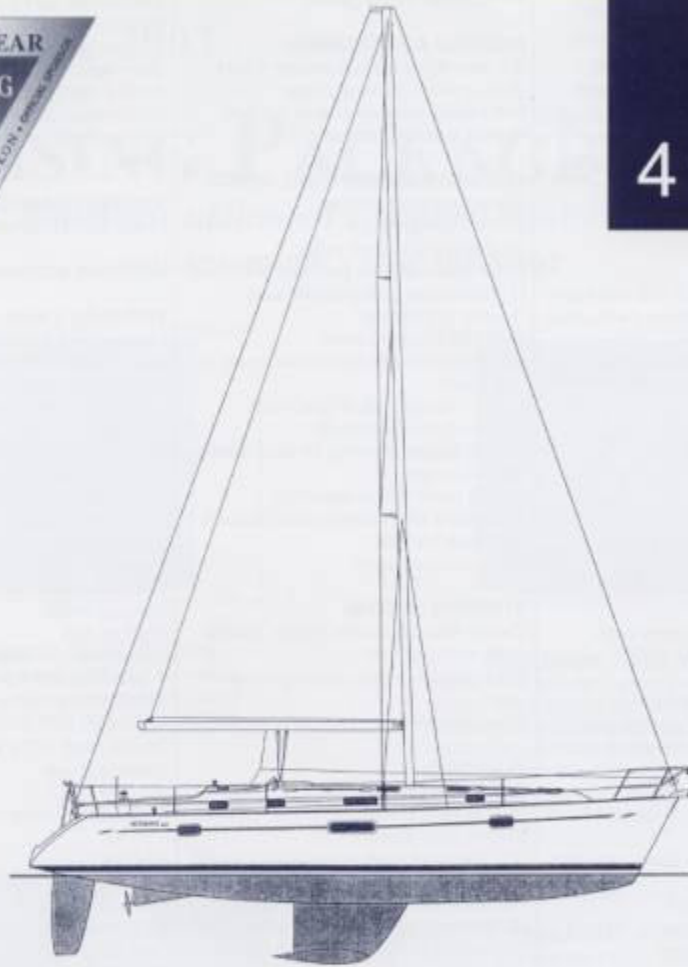

411



RIG DIMENSIONS		CLASSIC		FURLING		SPECIFICATIONS	
I.....	47.74 ft 14.55 m	47.74 ft 14.55 m	47.74 ft 14.55 m	47.74 ft 14.55 m	Designer.....	Groupe Finot	
J.....	16.31 ft 4.97 m	16.31 ft 4.97 m	16.31 ft 4.97 m	16.31 ft 4.97 m	L.O.A.....	41'8"	12.71m
P.....	41.54 ft 12.66 m	41.54 ft 12.66 m	41.54 ft 12.66 m	41.54 ft 12.66 m	Hull Length.....	40'6"	12.33m
E.....	14.83 ft 4.52 m	14.83 ft 4.52 m	14.83 ft 4.52 m	14.83 ft 4.52 m	L.W.L.	36'1"	11.00m
Mast Ht. over DWL	58' 6" 17.83 m	58' 6" 17.83 m	58' 6" 17.83 m	58' 6" 17.83 m	Beam.....	12'11"	3.96m
Sail Area					Displacement.....	17,196 lbs	7,800 kg
Genoa size	140%	140%	140%	140%	Draft - std.	4' 9"	1.45 m
Std. sail area	896 sq.ft. 83.3 sq.m	853 sq.ft. 79.2 sq.m	853 sq.ft. 79.2 sq.m	853 sq.ft. 79.2 sq.m	Ballast - std.	5,500 lbs	2,495 kg
					Draft - opt.	5' 7"	1.70 m
					Ballst - opt.	5,236 lbs	2,375 kg
					Fuel.....	39 gal	147 l
					Water.....	151 gal	550 l
					Auxiliary.....	40 hp	

SPECIFICATIONS

Includes all standard equipment listed below F.O.B. Marion, SC

The Beneteau 411 offers an amazingly spacious interior with beautiful, rich woodwork while providing performance and true ease of handling on the water. Her sharp lines and sumptuous comfort may catch your eye first, but it will be her sailing performance that confirms her rightful place in the Beneteau family.

CONSTRUCTION:

HULL: Laminated G.R.P. hull with internal fiberglass grid, reinforced with unidirectional rovings.

DECK: Balsa sandwich for stiffness, thermal and acoustic insulation, 360° bonded bulkheads.

RUNNING RIGGING:

- (1) Genoa halyard.
- (2) Genoa sheets.
- (1) Mainsheet.
- (1) Main boom topping lift led back to cockpit.
- (1) Main halyard.
- (1) Solid vang.
- (2) Mainsheet traveler control lines.

STANDING RIGGING:

Discontinuous S/S 1X19 rigging: forestay, twin backstays, upper and lower capshrouds, intermediates and aft lower shrouds.
Shroud roller on capshrouds.

SPARS:

Deck stepped, anodized aluminum roller furling mast.
Anodized, aluminum boom.
Deck collar with 6 blocks.
Double aft swept spreaders.

DECK GEAR:

- (2) Genoa sheet tracks.
- (2) Lewmar 48 CSTO genoa sheet winches, mounted on cockpit coaming.
- (2) Lewmar 40 CSTO halyard/control line winches.
- Profurl genoa roller furling with drum above deck.
- (1) Mainsheet track on coachroof.
- (2) Stoppers for mainsheet and traveler control lines.
- (6) Stoppers for control lines.
- (2) Stoppers for main and genoa halyard on mast.
- (2) Winch handles.

SAILS:

Roller furling mainsail.
140% Roller furling genoa.

MOORING & ANCHORING:

S/S bow fitting with (2) anchor rollers.
(6) Aluminum mooring cleats.
Self bailing anchor locker in the bow.
Manual anchor windlass.

EXTERIOR EQUIPMENT HULL & DECK:

Transom/cockpit shower.
(1) Port cockpit locker.
(1) Starboard cockpit locker.
(1) LP gas locker aft port side of cockpit.
(1) Helmsman seat provides easy access to transom.
Teak inlaid cockpit seats.
(1) Locker beneath helmsman's seat to starboard.
Halyard hangers aft of coachroof.
(2) Winch handle pockets.
Built-in dodger coaming for easy installation of dodger.
(4) S/S handrails on coachroof.
Side decks with molded raised bulwark with teak cap rail.
Swim platform locker.

STEERING SYSTEM:

Carbon fiber composite rudder, rudder tube and quadrant.
S/S leather wrapped steering wheel (42").
Emergency tiller.

PLUMBING:

Self-draining cockpit.
Manual bilge pump.
Electric bilge pump.
(2) Fiberglass fresh water tanks integrated into hull liner, total 158 gal.
Hot water heater - 6 gal. capacity.
(2) Rectangular S/S sinks in galley.
Heads feature fiberglass wash hand basin with combination faucet and hand shower with shower hose and support.
Fiberglass shower base with drain and electric shower drain pump.

ELECTRICAL SYSTEM:

Grounded rig.
Conduit for standard and optional wiring.
12 v. multi-function control panel.
110 v. shore power socket on transom.
110 v. control panel at chart table.
7 x 110v. outlets.
40 amp battery charger.
2 batteries - 1 x 100 amp engine battery, 1 x 200 amp battery.

Lights:

Flush mounted halogen lights.
Fluorescent light in galley and heads.
Reading light in each cabin.
Bi-color navigation light.
Stern light.
Anchor light.
Combination deck and steaming light.
Mini spot light white/red lens at chart table.

PROPANE GAS CIRCUIT

Force Ten (2) burner stove with oven.

INTERIOR ACCOMMODATIONS:

FORWARD CABIN:

Headroom 6' 3"
Double berth (67" x 49")
Shelf on hull, starboard side.
(2) Drawers and (1) storage locker under the berth.
(1) Hanging locker.
(1) Settee and storage locker.
Storage shelf on hull, port side.
(1) Cabinet/storage locker.
2 Cabin Version - Aft Cabin:
Headroom 6' 4"
Double berth 67" x 61" at shoulder.
Hanging locker.
Shelf on hull.
Seat inboard of hanging locker.
3 Cabin Version Port & Starboard Aft Cabin:
Headroom 6' 4"
Double berth 67" x 49" at shoulders.
Hanging locker.
Shelf on hull.
Seat inboard of hanging locker.

SALON:

Maximum 6' 4" headroom.
U-shaped dinette.
(2) Lockers with louvered and glass rack above dinette.
Storage locker behind dinette.
Storage and access to plumbing and hot water heater under dinette.
Expandable table with leaf, converts into double berth with filler cushion.
AM/FM stereo/CD player with (4) speakers.
3 Cabin Version Salon:
Central settee with storage underneath.

GALLEY:

Max headroom 6' 4".
Stove protection bar.
Plastic storage baskets.
Tableware drawer.
Lockers above work space.

Trash can.
 2 Cabin Version Galley:
 Formica countertop.
 Front and top opening fiberglass icebox.
 12 v. refrigeration unit.
 12 v. freezer unit.
 3 Cabin Version Galley:
 Formica work space surrounding sink.
 Formica counter above refrigerator and behind stove.

CHART TABLE: (3 Cabin)

Storage locker with shelf under chart table.
 Panel for installation of electronics.
 Navigators seat with storage underneath.

HEADS:

Manual marine toilet with 13.5 gal. holding tank (aft head)
 Manual marine toilet 15 gal holding tank (fwd head).
 Fiberglass sink, medicine cabinet, mirror and toilet accessories.

COMPANIONWAY:

Headroom 6'5".
 2-part, hinging, fiberglass companionway with gas spring for easy access to engine room.
 (2) Wooden handrails on companionway bulkheads.

INTERIOR UPHOLSTERY

Wood paneling on hull sides.
 Fiberglass headliner in heads.
 White vinyl headliner in salon and forward cabin.

BALLAST

Shoal draft cast iron bulb keel (4'9" draft).

ENGINE EQUIPMENT

Westerbeke 42B4, 40hp engine.
 39 gal. fuel capacity.
 Aluminum fuel tank.
 Engine control panel on cockpit table.
 3-Bladed fixed prop.
 Soundproof insulation in engine room.
 Engine raw water filter.
 Racor fuel/water separator.

VENTILATION

2 CABIN

(1) Opening port Lewmar (4" x 10") in cockpit opening into galley.

(1) Opening port Lewmar (4" x 10") in cockpit opening into aft port cabin.
 (2) Fixed hull portlights (36 1/4" x 8 3/16") accessing into salon.
 (1) Fixed hull portlight (16 9/16" x 8 3/16") accessing into aft port cabin.
 (1) Fixed hull portlight (16 9/16" x 8 3/16") accessing into galley.
 (2) Fixed hull portlights (16 9/16" x 8 3/16") accessing into forward cabin.

3 CABIN

(2) Opening ports Lewmar (4" x 10") in cockpit opening into aft port and aft starboard cabins.
 (1) Fixed hull portlight (36 1/4" x 8 3/16") accessing into salon.
 (1) Fixed hull portlight (36 1/4" x 8 3/16") accessing into galley.
 (1) Fixed hull portlight (16 9/16" x 8 3/16") accessing into aft port cabin.
 (1) Fixed hull portlight (16 9/16" x 8 3/16") accessing into aft starboard cabin.
 (2) Fixed hull portlights (16 9/16" x 8 3/16") accessing into forward cabin.

COACHROOF

All Versions

(1) Lewmar size 54 hatch opening into forward head.
 (2) Lewmar size 30 hatches opening into forward cabin.
 (2) Opening ports Lewmar size 0 opening into forward cabin.
 (1) Low profile cowl vent ventilating aft port head.
 (1) Opening port Lewmar size 1 opening into aft port head.
 (1) Lewmar size 20 hatch opening into aft port cabin.
 (1) Opening port Lewmar size 1 opening into aft port cabin.
 (1) PMMA sliding hatch opening into companionway and 2 weather boards.

COACHROOF 2 CABIN

(2) Lewmar size 30 hatches opening into salon.
 (2) Opening ports Lewmar size 4 opening into salon.
 (1) Low profile cowl vent ventilating galley.
 (1) Lewmar size 20 hatch opening into galley.
 (1) Opening port Lewmar size 1 opening into galley.
 (1) Opening port Lewmar size 1 opening into galley.

COACHROOF 3 CABIN

(1) Lewmar size 30 hatch opening into salon.
 (1) Opening port Lewmar size 4 opening into salon.
 (1) Lewmar size 30 hatch opening into galley.
 (1) Opening port Lewmar size 4 opening into galley.
 (1) Low profile cowl vent on coachroof ventilating starboard chart table.
 (1) Opening port Lewmar size 1 opening starboard chart table.
 (1) Lewmar size 20 hatch opening into starboard chart table.
 (1) Opening port Lewmar size 1 opening into starboard chart table.

INTERIOR WOODWORK

Cherry stained wood finish.

AVAILABLE VERSIONS

· 2 Cabins, 2 Heads.
 · 3 Cabins, 2 Heads.

AVAILABLE OPTIONS

· Air Conditioning.
 · Autopilot.
 · Classic mast with full batten mainsail.
 · Gennaker Gear.
 · Screens.
 · Electric Windlass.
 · Deep bulb keel (57" draft).

CRUISING PACKAGE

(Additional standard equipment.)
 · Raytheon ST60 Tridata
 · Raytheon ST60 Wind
 · Standard Intrepid VHF with Antenna
 · Stereo
 · CD Multi-Changer
 · Sternrail seats
 · Microwave
 · Shore Power Cord
 · Hot & Cold Cockpit Shower

The manufacturer reserves the right to alter equipment and specifications without notice. All specifications are approximations and are not contractual in nature.

BENETEAU 411

DECK LAYOUT

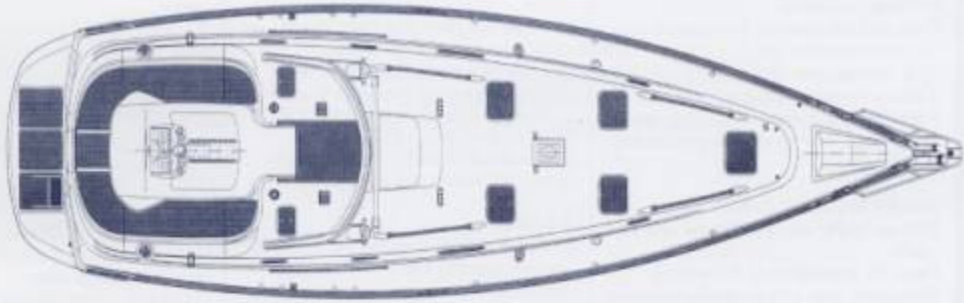

INTERIOR LAYOUTS

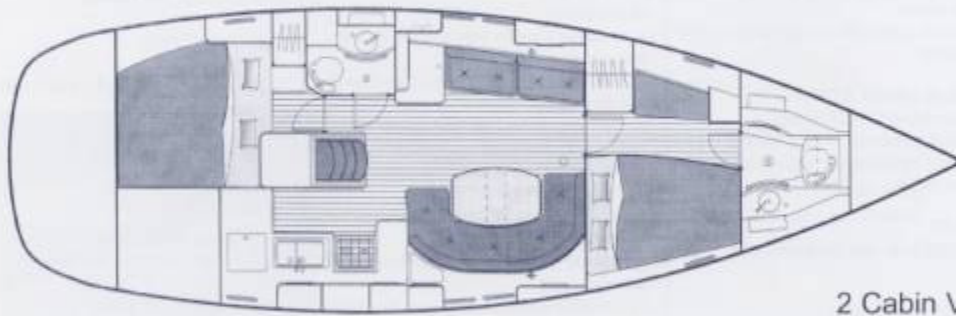

2 Cabin Version

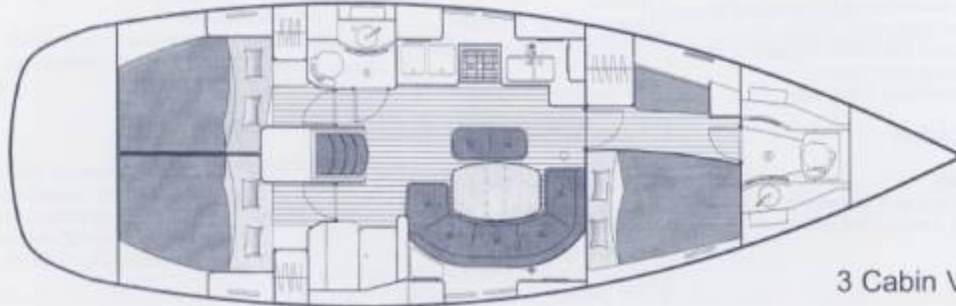

3 Cabin Version

BENETEAU USA • 24 NORTH MARKET STREET, SUITE 201 • CHARLESTON, SC • 29401
(843) 805-5000 • FAX (843) 805-5010 • www.beneteauusa.com
Customer Service: (843) 423-6459 • Fax: (843) 423-5516

9/02